

RED LASER DIODE

DL-5148-030

Tentative



Ver.2 Feb. 2006

Features

- Short wavelength : 638 nm (Typ.)
- Output power : 20 mW (CW)
- Threshold current : $I_{th} = 60$ mA (Typ.)
- Operating voltage : $V_{op} = 2.3$ V (Typ.)

Applications

- Leveler
- Bar-code scanner
- Line marker

Absolute Maximum Ratings

($T_c=25^\circ\text{C}$)

Parameter		Symbol	Ratings	Unit
Light Output	CW	P_o (CW)	25	mW
Reverse Voltage	Laser	VR	2	V
	PD		30	
Operating Temperature		T_{opr}	-10 to +50	$^\circ\text{C}$
Storage Temperature		T_{stg}	-40 to +85	$^\circ\text{C}$

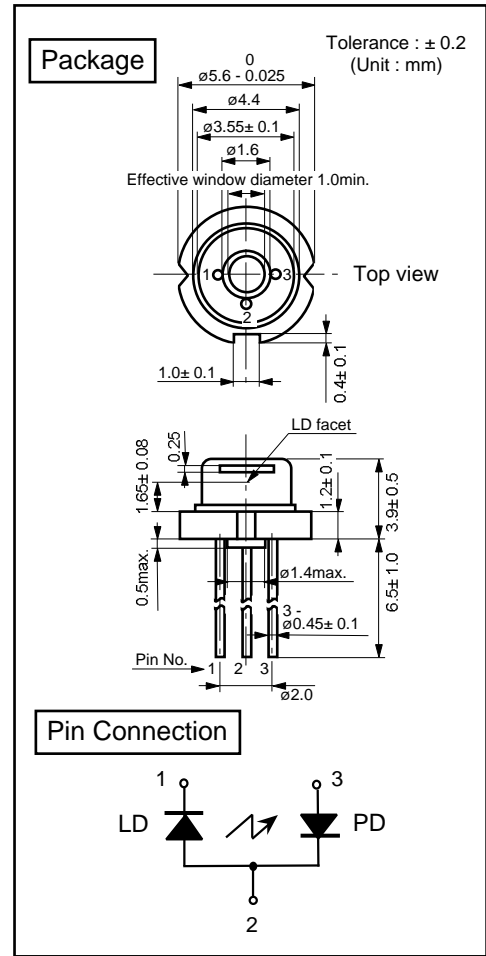

Electrical and Optical Characteristics ^{1) 2)}

($T_c=25^\circ\text{C}$)

Parameter		Symbol	Condition	Min.	Typ.	Max.	Unit
Threshold Current		I_{th}	CW	-	60	85	mA
Operating Current		I_{op}	$P_o=20\text{mW}$	-	80	105	mA
Operating Voltage		V_{op}	$P_o=20\text{mW}$	-	2.3	2.7	V
Lasing Wavelength		L_p	$P_o=20\text{mW}$	-	638	645	nm
Beam ³⁾ Divergence	Perpendicular	Q_v	$P_o=20\text{mW}$	12	16	22	$^\circ$
	Parallel	Q_h	$P_o=20\text{mW}$	6	8	12	$^\circ$
Off Axis Angle	Perpendicular	dQ_v	-	-3	-	3	$^\circ$
	Parallel	dQ_h	-	-2.5	-	2.5	$^\circ$
Differential Efficiency		SE	-	0.7	1.0	1.2	mW/mA
Monitoring Output Current		I_m	$P_o=20\text{mW}$	0.1	0.3	0.6	mA

1) Initial values 2) All the above values are evaluated with Tottori Sanyo's measuring apparatus
 3) Full angle at half maximum

Note : The above product specification are subject to change without notice.

Characteristics

Output power vs. Forward current

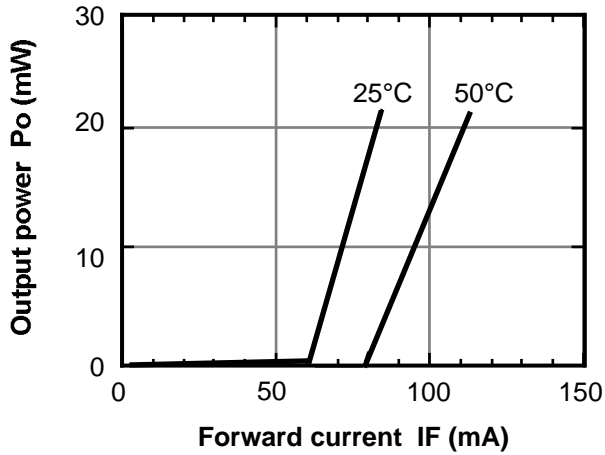

Threshold current vs. Temperature

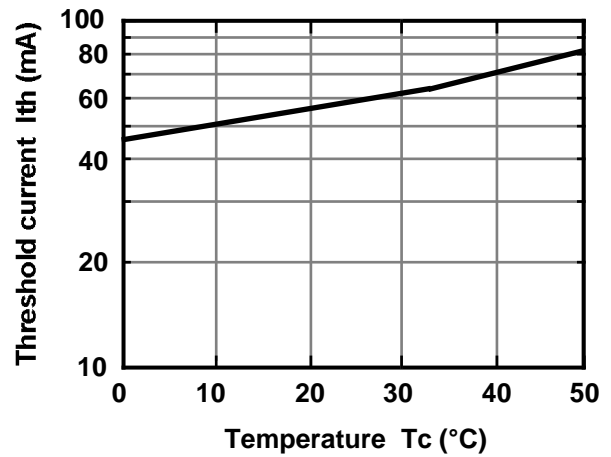

Monitoring current vs. Output power

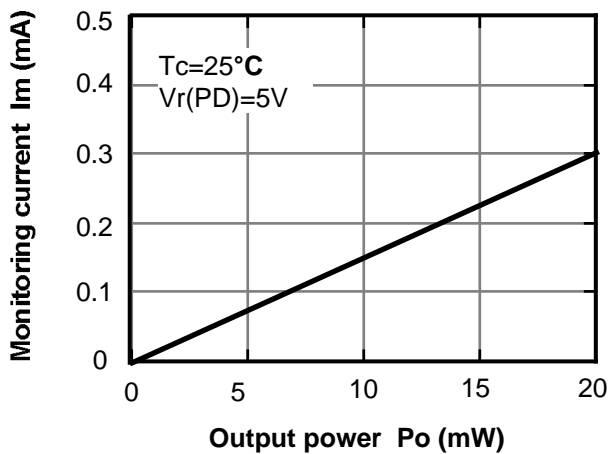

Beam divergence

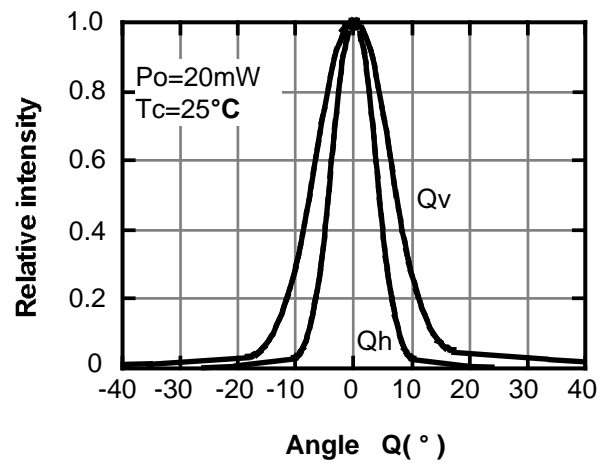

Lasing wavelength vs. Temperature

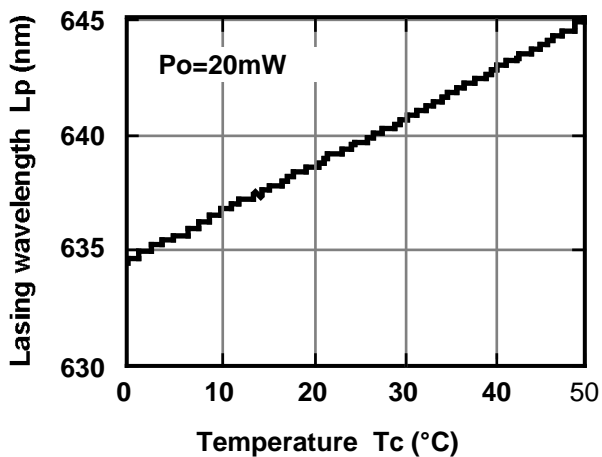

Lasing wavelength vs. Output power

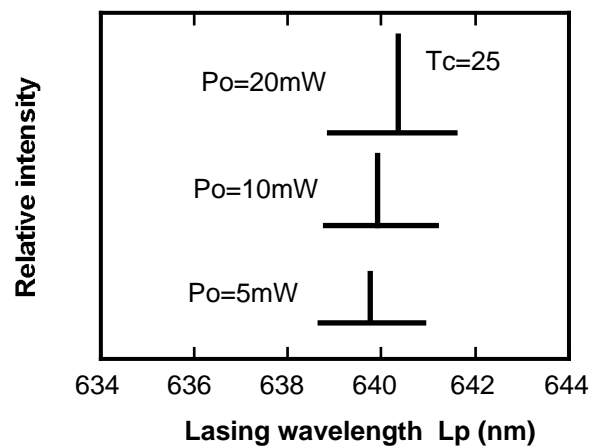

This is typical data and it may not represent all products.